

2 BEDROOMS + DEN

WILLOW

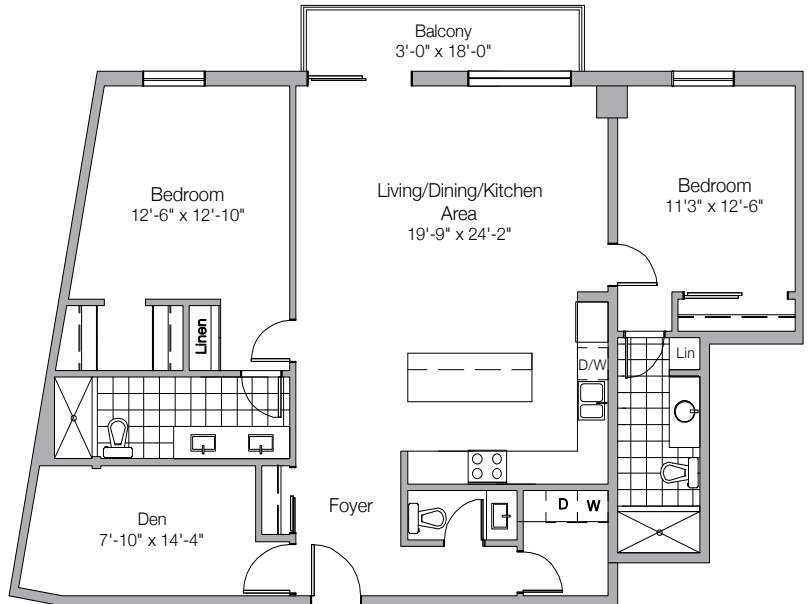

DESCRIPTION

Two bedrooms plus den, 2 ensuite baths, 2 piece powder room and balcony.

SIZE

1441 SQ.FT.

AVAILABILITY

One unit per floor.

HIGHLIGHTS

Laminate flooring in principal rooms; High quality porcelain limestone in kitchen, foyer, bathrooms and laundry areas; Four high quality stainless steel appliances plus washer and dryer in laundry room. Brushed nickel interior hardware and door levers; Superior quality kitchen and bathroom cabinets and vanity; Quartz countertops; Full width mirror over vanity in all bathrooms; Interconnected smoke and carbon monoxide alarms; Individual unit controlled air conditioning and heating system; TV cable outlets in the living room and bedrooms; Multiple telephone jacks.

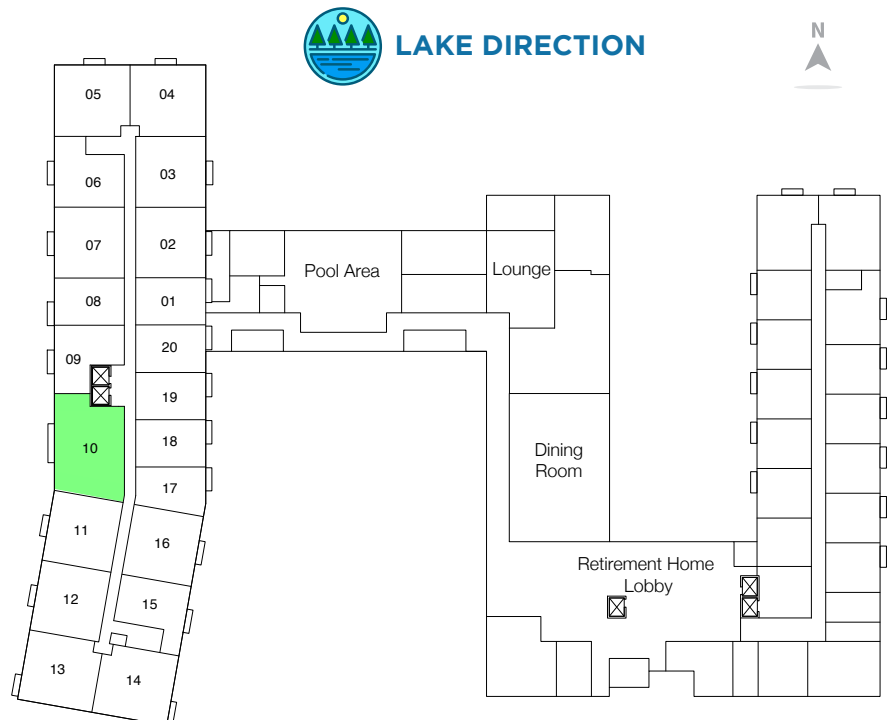

Little Lake Drive



All prices, figures, and materials are preliminary and subject to change without notice E.&O.E. June 1st, 2018.

10 Little Lake Drive
Barrie, ON L4M 7C1

705-719-9909
info@thelandingatlittlelake.com

www.thelandingatlittlelake.com